

## Health Plan for Student with Allergies

Student  
Picture  
Here

Name: \_\_\_\_\_  
Student ID: \_\_\_\_\_  
Mother: \_\_\_\_\_  
Work Phone: \_\_\_\_\_  
Cell Phone: \_\_\_\_\_  
Physician: \_\_\_\_\_

Teacher/HR: \_\_\_\_\_  
Father: \_\_\_\_\_  
Work Phone: \_\_\_\_\_  
Cell Phone: \_\_\_\_\_  
Phone Number: \_\_\_\_\_

### Extremely reactive to the following foods: \_\_\_\_\_

#### Therefore:

- ☐ If checked, give epinephrine immediately for ANY symptoms if the allergen was *likely* eaten.  
☐ If checked, give epinephrine immediately if the allergen was *definitely* eaten, even if no symptoms are noted.

### Any SEVERE SYMPTOMS after suspected or known ingestion: One or more of the following:

LUNG: Short of breath, wheeze, repetitive cough  
HEART: Pale, blue, faint, weak pulse, dizzy, confused  
THROAT: Tight, hoarse, trouble breathing/swallowing  
MOUTH: Obstructive swelling (tongue and/or lips)  
SKIN: Many hives over body, widespread redness  
GUT: Repetitive vomiting, severe diarrhea  
OTHER: feeling something bad is about to happen, anxiety, confusion

#### Or combination of symptoms from different body areas:

SKIN: Hives, itchy rashes, swelling (i.e., eyes, lips)  
STOMACH: Vomiting, crampy pain

### MILD SYMPTOMS ONLY:

NOSE: Itchy or runny nose, sneezing  
MOUTH: Itchy mouth  
SKIN: A few hives around mouth/face, mild itch  
STOMACH: Mild nausea/discomfort

### Medications/Doses

Epinephrine (brand and dose): \_\_\_\_\_  
Antihistamine (brand and dose): \_\_\_\_\_  
Other (i.e., inhaler-bronchodilator, if asthmatic): \_\_\_\_\_

### Monitoring:

- Stay with the student, and alert healthcare professionals and parent.
- Tell rescue squad epinephrine was given; request an ambulance with epinephrine. Note time when epinephrine was administered. A second dose of epinephrine can be given five minutes or more after the first if symptoms persist or recur.
- For a severe reaction, consider keeping student lying on back with legs raised. Treat student even if parents cannot be reached. See back/attached for auto-injection technique.

### 1. INJECT EPINEPHRINE IMMEDIATELY

- Call 911
- Begin monitoring (see below)
- Give additional medications\*:
  - Antihistamine
  - Inhaler (bronchodilator), if asthma

\*Antihistamines and inhalers/bronchodilators are not to be depended upon to treat a severe reaction (anaphylaxis). Use EPINEPHRINE.

- GIVE ANTIHISTAMINE
- Stay with student; alert health care professionals and parent
- If symptoms progress (see above), USE EPINEPHRINE
- Begin monitoring (see below)

FOR MILD SYMPTOMS FROM  
MORE THAN ONE SYSTEM  
AREA, GIVE EPINEPHRINE

### Epi Pen is located in:

\_\_\_\_\_ Child Carries  
\_\_\_\_\_ Health Office  
\_\_\_\_\_ Main Office  
\_\_\_\_\_ Cafeteria  
\_\_\_\_\_ Child's Backpack  
\_\_\_\_\_ Classroom  
\_\_\_\_\_ Other \_\_\_\_\_

Parent/Guardian Signature \_\_\_\_\_

Date \_\_\_\_\_

Physician/Healthcare Provider Signature \_\_\_\_\_

Date \_\_\_\_\_



**FARE**  
Food Allergy Research & Education

# FOOD ALLERGY & ANAPHYLAXIS EMERGENCY CARE PLAN

## HOW TO USE AUVI-Q® (EPINEPHRINE INJECTION, USP), KALEO

1. Remove Auvi-Q from the outer case. Pull off red safety guard.
2. Place black end of Auvi-Q against the middle of the outer thigh.
3. Press firmly until you hear a click and hiss sound, and hold in place for 2 seconds.
4. Call 911 and get emergency medical help right away.

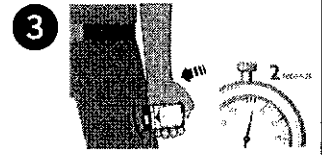

## HOW TO USE EPIPEN®, EPIPEN JR® (EPINEPHRINE) AUTO-INJECTOR AND EPINEPHRINE INJECTION (AUTHORIZED GENERIC OF EPIPEN®), USP AUTO-INJECTOR, MYLAN AUTO-INJECTOR, MYLAN

1. Remove the EpiPen® or EpiPen Jr® Auto-Injector from the clear carrier tube.
2. Grasp the auto-injector in your fist with the orange tip (needle end) pointing downward. With your other hand, remove the blue safety release by pulling straight up.
3. Swing and push the auto-injector firmly into the middle of the outer thigh until it 'clicks'. Hold firmly in place for 3 seconds (count slowly 1, 2, 3).
4. Remove and massage the injection area for 10 seconds. Call 911 and get emergency medical help right away.

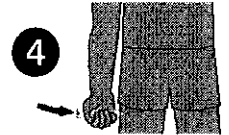

## HOW TO USE IMPAX EPINEPHRINE INJECTION (AUTHORIZED GENERIC OF ADRENALCLICK®), USP AUTO-INJECTOR, AMNEAL PHARMACEUTICALS

1. Remove epinephrine auto-injector from its protective carrying case.
2. Pull off both blue end caps: you will now see a red tip. Grasp the auto-injector in your fist with the red tip pointing downward.
3. Put the red tip against the middle of the outer thigh at a 90-degree angle, perpendicular to the thigh. Press down hard and hold firmly against the thigh for approximately 10 seconds.
4. Remove and massage the area for 10 seconds. Call 911 and get emergency medical help right away.

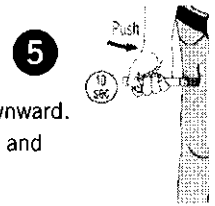

## HOW TO USE TEVA'S GENERIC EPIPEN® (EPINEPHRINE INJECTION, USP) AUTO-INJECTOR, TEVA PHARMACEUTICAL INDUSTRIES

1. Quickly twist the yellow or green cap off of the auto-injector in the direction of the "twist arrow" to remove it.
2. Grasp the auto-injector in your fist with the orange tip (needle end) pointing downward. With your other hand, pull off the blue safety release.
3. Place the orange tip against the middle of the outer thigh at a right angle to the thigh.
4. Swing and push the auto-injector firmly into the middle of the outer thigh until it 'clicks'. Hold firmly in place for 3 seconds (count slowly 1, 2, 3).
5. Remove and massage the injection area for 10 seconds. Call 911 and get emergency medical help right away.

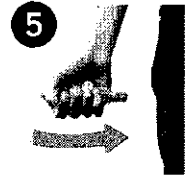

## HOW TO USE SYMJEPI™ (EPINEPHRINE INJECTION, USP)

1. When ready to inject, pull off cap to expose needle. Do not put finger on top of the device.
2. Hold SYMJEPI by finger grips only and slowly insert the needle into the thigh. SYMJEPI can be injected through clothing if necessary.
3. After needle is in thigh, push the plunger all the way down until it clicks and hold for 2 seconds.
4. Remove the syringe and massage the injection area for 10 seconds. Call 911 and get emergency medical help right away.
5. Once the injection has been administered, using one hand with fingers behind the needle slide safety guard over needle.



## ADMINISTRATION AND SAFETY INFORMATION FOR ALL AUTO-INJECTORS:

1. Do not put your thumb, fingers or hand over the tip of the auto-injector or inject into any body part other than mid-outer thigh. In case of accidental injection, go immediately to the nearest emergency room.
2. If administering to a young child, hold their leg firmly in place before and during injection to prevent injuries.
3. Epinephrine can be injected through clothing if needed.
4. Call 911 immediately after injection.

**OTHER DIRECTIONS/INFORMATION** (may self-carry epinephrine, may self-administer epinephrine, etc.):

Treat the person before calling emergency contacts. The first signs of a reaction can be mild, but symptoms can worsen quickly.

### EMERGENCY CONTACTS — CALL 911

RESCUE SQUAD: \_\_\_\_\_

DOCTOR: \_\_\_\_\_ PHONE: \_\_\_\_\_

PARENT/GUARDIAN: \_\_\_\_\_ PHONE: \_\_\_\_\_

### OTHER EMERGENCY CONTACTS

NAME/RELATIONSHIP: \_\_\_\_\_ PHONE: \_\_\_\_\_

NAME/RELATIONSHIP: \_\_\_\_\_ PHONE: \_\_\_\_\_

NAME/RELATIONSHIP: \_\_\_\_\_ PHONE: \_\_\_\_\_